

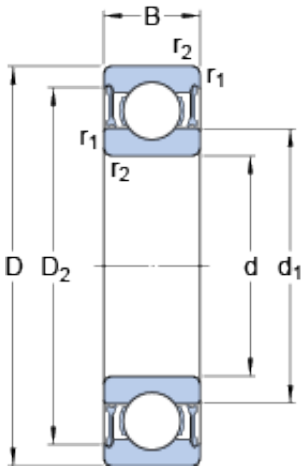

BFO Bearing Factory



25 mm x 32 mm x 4 mm 25 mm x 32 mm x 4 mm SKF W 61705-2RZ deep groove ball bearings

Bearing No. W 61705-2RZ

W 61705-2RZ Bearing 2D drawings and 3D CAD models

Size	32x25x4 mm
Bore Diameter	32 mm
Outer Diameter	25 mm
Width	4 mm
d	25 mm
D	32 mm
B	4 mm
d ₁	27.27 mm
D ₂	30.29 mm
r _{1,2} - min.	0.2 mm
D _a - max.	30.5 mm
r _a - max.	0.2 mm
Basic dynamic load rating - C	0.618 kN
Basic static load rating - C ₀	0.465 kN
Fatigue load limit - P _u	0.02 kN
Reference speed	43000 r/min
Limiting speed	20000 r/min
Calculation factor - k _r	0.015
Calculation factor - f ₀	8.8
d ₁	27.27 mm
D ₂	30.29 mm
r _{1,2} min.	0.2 mm
d _a min.	26.5 mm
d _a max.	27 mm



BFO Bearing Factory

D_a max.	30.5 mm
r_a max.	0.2 mm
Basic dynamic load rating C	0.618 kN
Basic static load rating C_0	0.465 kN
Fatigue load limit P_u	0.02 kN
Calculation factor k_r	0.015
Calculation factor f_0	8.8
Mass bearing	0.0068 kg